



16 Wellmeadow Close, Newton Mearns, G77 6QW

www.nicolestateagents.co.uk



Nicol Estate Agents



Nicol Estate Agents

Situation

A hugely popular suburb, Newton Mearns is a welcoming, family friendly town, with a fantastic, lively and inclusive community. If you choose to live in Newton Mearns, you will have access to some of Scotland's highest attaining primary and secondary schools, including Crookfur Primary School, St Cadoc's Primary School, Eastwood High School and St. Ninian's High School. Newton Mearns is within easy reach of the private Belmont House School and several school-run pick-up points for private schools in Glasgow.

Newton Mearns is located approximately 9 miles from Glasgow City Centre. Commuter routes are served by the M77, M8 and Glasgow Orbital motorways which also provide 30 minute journey times to both Glasgow and Prestwick international airports. There are regular train and bus services to Glasgow, East Kilbride and the beautiful Ayrshire coast.

Recognised as providing amongst the highest standards of local amenities, Newton Mearns offers an array of healthcare centres, banks and libraries and a broad range of supermarkets, boutique shops and restaurants, including The Avenue Shopping Centre. Only a short walk away, is the Greenlaw Retail Park which includes Waitrose, Tesco Metro, Aldi and a wide range of bars and restaurants.

Local sports and recreational facilities include David Lloyd's, Parklands Country Club, Williamwood and Whitecraigs Golf Clubs, a number of private bowling clubs and Whitecraigs tennis and rugby club. East Renfrewshire Council's own excellent sports and leisure facilities at Eastwood Toll. If you are an outdoors lover, Rouken Glen Park, voted Best Park in the UK 2016, is nearby with walking trails through the woods, a great adventure play area, a skate park, five a side football pitches and a boating pond.







Nicol Estate Agents

Property Description

A well presented main door two bedroom upper flat, with a private garden and garage, located within the continually popular Wellmeadow development, close to local amenities.

The property has been well maintained and upgraded by the present owner and comprises:

Ground Floor: Entrance hall with staircase to upper floor and storage cupboard. Utility room. Door to rear.

First Floor: Upper landing with cupboard. Bright and spacious sitting/dining room. Well appointed kitchen fitted with floor standing units and complementary worktop surfaces. Double bedroom with fitted wardrobes and shelved storage cupboard. An attractive bathroom with three piece suite and shower over the bath completes the accommodation.

The property is complemented by gas central heating, replacement double glazing and has landscaped enclosed rear garden. A driveway provides off street parking and leads to a single garage.

www.nicolestateagents.co.uk







16 Wellmeadow Close, Newton Mearns

Approximate Gross Internal Area

840 sq ft - 78.03 sq m

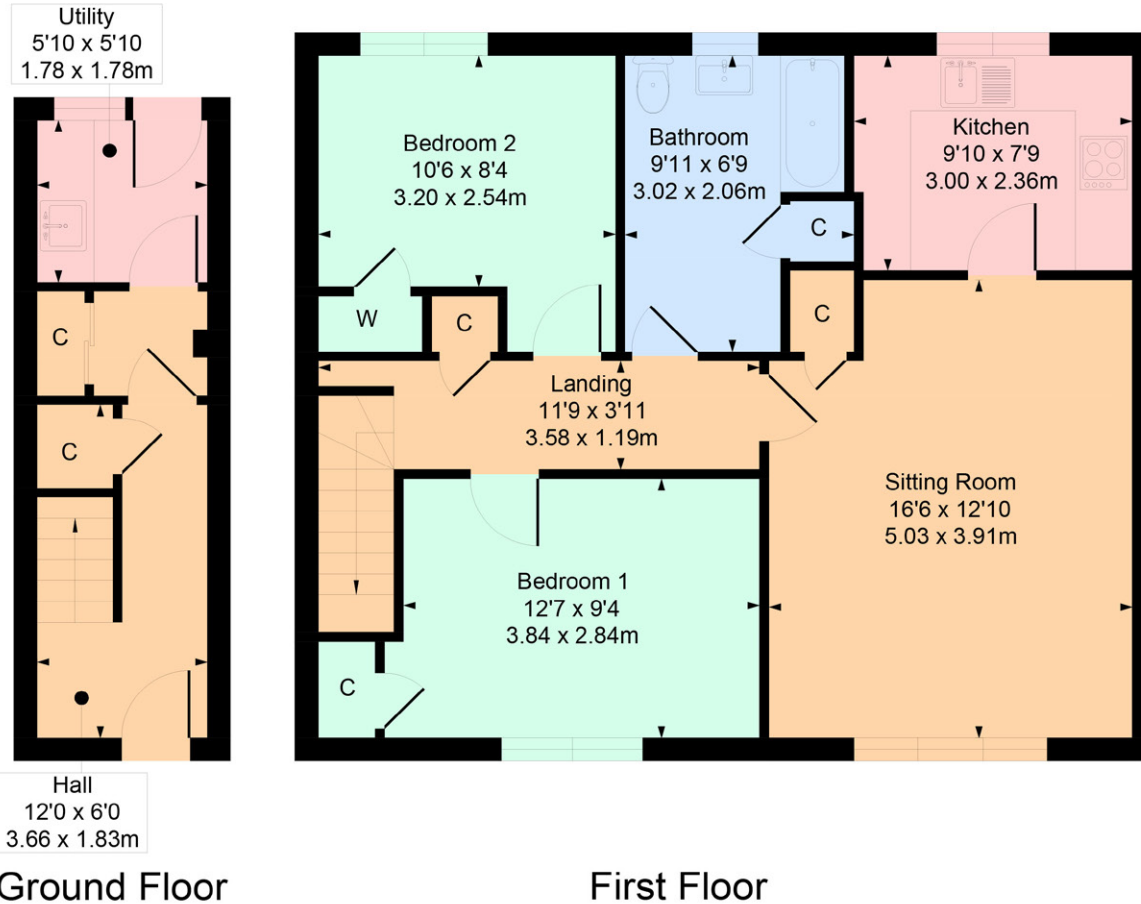

SKETCH PLAN FOR ILLUSTRATIVE PURPOSES ONLY All measurements, walls, doors, windows, fitting and appliances, their sizes and locations are approximate only. They cannot be regarded as being a representation by the seller, nor their agent. We believe these details to be accurate however it is not guaranteed and they do not form any part of a contract. Fixtures and fittings are not included unless specified in the enclosed. Photographs are for general information and it must not be inferred that any item is included for sale with the property.



Nicol Estate Agents

Viewing

By appointment through
Nicol Estate Agents
Newton Mearns

Outgoings

East Renfrewshire Council
Band D

Fixtures & Fittings

Only items specifically mentioned in the sale
particulars are included in the sale price.

Energy Efficiency Rating

Band C

Services

The property will be supplied by mains water, gas
and electricity. Gas central heating.

Local Authority

East Renfrewshire Council
Council headquarters
Eastwood Park
Rouken Glen Road
Giffnock G46 6UG
Tel: (0141) 577 3000

Property Reference

3386