



62 Castle Court, 3 Kings Drive, Newton Mearns G77 5TB

www.nicolestateagents.co.uk



Nicol Estate Agents





Nicol Estate Agents

Situation

Newton Mearns is located approximately 9 miles from Glasgow City Centre. Commuter routes are served by the M77, M8 and Glasgow Orbital motorways which also provide 30 minute journey times to both Glasgow and Prestwick international airports. There are regular train and bus services to Glasgow, East Kilbride and the beautiful Ayrshire coast.

A hugely popular suburb, Newton Mearns is a welcoming, family friendly town, with a fantastic, lively and inclusive community. If you choose to live in Newton Mearns, you will have access to some of Scotland's highest attaining primary and secondary schools, including Kirkhill, St Claire's and Calderwood Lodge Primary Schools, Mearns Castle and St. Ninian's High Schools..

Newton Mearns is acknowledged for the high standard of local amenities and provides a selection of local shops, supermarkets, restaurants, regular bus and rail services to Glasgow City Centre, banks, library and health care facilities. Kings Drive is conveniently located for access to The Avenue Shopping Centre, Greenlaw Village Retail Park and is with walking distance to the local shops, restaurants and healthcare facilities on Mearns Road and Broom Park.

Local sports and recreational facilities include David Lloyd Rouken Glen, Parklands Country Club, Cathcart, Williamwood and Whitecraigs Golf Clubs, Whitecraigs Tennis Club as well as East Renfrewshire Council's own excellent sports and leisure facilities at Eastwood Toll. If you are an outdoors lover, Rouken Glen Park, voted Best Park in the UK 2016, is nearby with walking trails through the woods, a great adventure play area, a skate park, five a side football pitches and a boating pond.









Nicol Estate Agents

A well presented two bedroom ground floor flat located in the sought after location of Newton Mearns and is extremely well positioned for local amenities within the surrounding district.

The accommodation comprises:

Well kept communal entrance hall and stairwell. Reception hallway with good storage. Bright and spacious dual aspect sitting / dining room with open outlook. The modern kitchen is fitted with a range of wall mounted and floor standing units and complementary worktop surfaces. Two double bedrooms. Bathroom with three piece suite.

The property is further complemented by electric heating and double glazing.



62 Castle Court, Kings Drive, Newton Mearns

Approximate Gross Internal Area
786 sq ft - 73.02 sq m

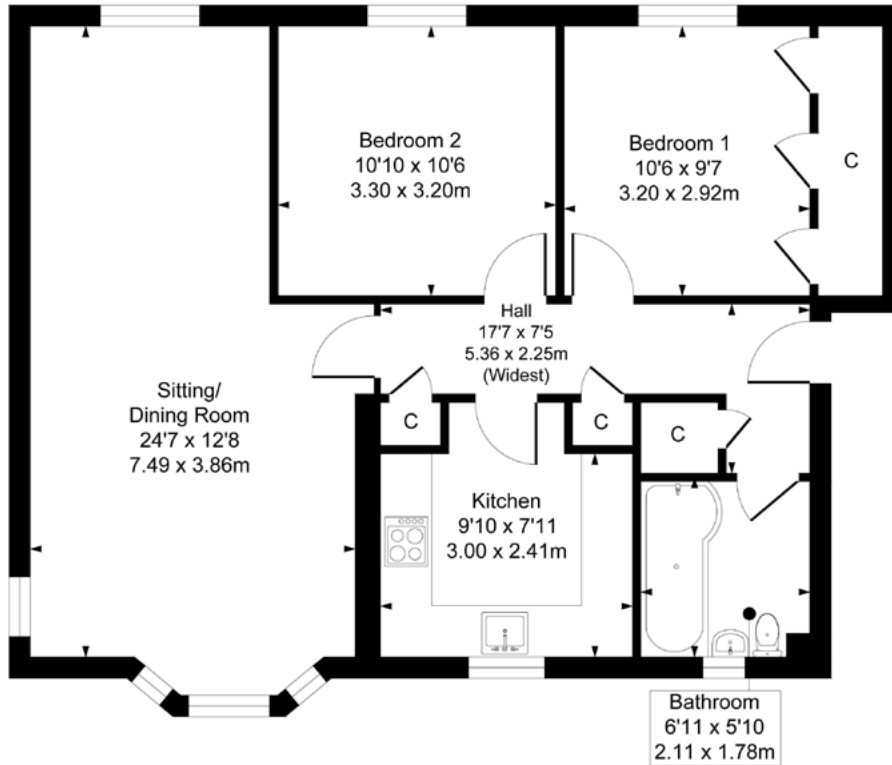

SKETCH PLAN FOR ILLUSTRATIVE PURPOSES ONLY All measurements, walls, doors, windows, fitting and appliances, their sizes and locations are approximate only. They cannot be regarded as being a representation by the seller, nor their agent. We believe these details to be accurate however it is not guaranteed and they do not form any part of a contract. Fixtures and fittings are not included unless specified in the enclosed. Photographs are for general information and it must not be inferred that any item is included for sale with the property.



Nicol Estate Agents

Viewing

By appointment through
Nicol Estate Agents
Newton Mearns

Outgoings

East Renfrewshire Council
Band D

Fixtures & Fittings

Only items specifically mentioned in the sale particulars are included in the sale price.

Energy Efficiency Rating

Band E

Services

The property will be supplied by mains water, drainage and electricity. Electric central heating.

Local Authority

East Renfrewshire Council
Council headquarters
Eastwood Park
Rouken Glen Road
Giffnock G46 6UG
Tel: (0141) 577 3000

Property Reference

3623

46 Ayr Road, Newton Mearns, Glasgow G46 6SA | 0141 616 3960 | fax 0141 258 2761 | mail@nicolestateagents.co.uk

1 Helena Place, Busby Road, Clarkston, G76 7RB | 0141 638 4541 | fax 0141 258 2761 | clarkston@nicolestateagents.co.uk



www.nicolestateagents.co.uk